

**Sixty Parkside 95-060 Waikalani Drive Unit C302, Mililani 96789 \* Sixty Parkside \***

**\$625,000**

Beds: **3**  
 Bath: **2/0**  
 Living Sq. Ft.: **1,212**  
 Land Sq. Ft.: **0**  
 Lanai Sq. Ft.: **58**  
 Sq. Ft. Other: **0**  
 Total Sq. Ft. **1,270**

MLS#: **202411394, FS**  
 Status: **Active**  
 List Date & DOM: **05-29-2024 & 28**  
 Condition: **Excellent, Above Average**  
 Frontage:  
 Tax/Year: **\$159/2024**  
 Neighborhood: **Waipio Acres-waikalani Woodlands**

Year Built: **2011**  
 Remodeled: **2021**  
 Total Parking: **2**  
[Assessed Value](#)  
 Building: **\$325,700**  
 Land: **\$193,200**  
 Total: **\$638,900**

Maint./Assoc. **\$625 / \$0**

[Flood Zone](#): **Zone D - Tool**

Stories / CPR: **One / No**

Parking: **Covered - 1, Open - 1**

Frontage:

[Zoning](#): **11 - A-1 Low Density Apartment**

View: **Other**

**Public Remarks:** Experience the ideal blend of space, style, and affordability in this serene unit that offers the comfort of a single-family home without the high price tag. Nestled at the end of the road in a pet-friendly community, this complex provides gated entry for enhanced privacy and security. Sixty Parkside, a newer building, features an updated sprinkler system in every room and common areas. The community includes an on-site resident manager, two deeded parking spaces, video security, and elevators for easy floor access. Step into a modern, move-in ready space with updated flooring and countertops. Enjoy the convenience of a split AC system, in-unit washer, dryer, and dishwasher. The open kitchen flows into the living room, perfect for entertaining. With a versatile three-bedroom floor plan, you'll have the space you need now and room to grow later. Located in Mililani, you'll be near top-rated schools, great restaurants, and shopping. A short drive takes you to the North Shore's best beaches, surf spots, and snorkeling. Military personnel will enjoy the easy commute to Wheeler Army Airfield and Schofield Barracks. Call your realtor today, Sixty Parkside is ready to welcome you! **Sale Conditions:** None  
**Schools:** , , \* [Request Showing](#), [Photos](#), [History](#), [Maps](#), [Deed](#), [Watch List](#), [Tax Info](#)

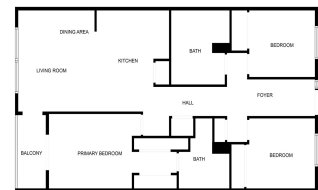

Address	Price	Bd & Bth	Living / Avg.	Land   Avg.	Lanai	Occ.	FL	DOM
<a href="#">95-060 Waikalani Drive C302</a>	<a href="#">\$625,000</a>	3 & 2/0	1,212   \$516	0   \$inf	58	50%	3	28

Address	Tax   Maint.   Ass.	Assessed Land	Assessed Building	Assessed Total	Ratio	Year & Remodeled
<a href="#">95-060 Waikalani Drive C302</a>	\$159   \$625   \$0	\$193,200	\$325,700	\$638,900	98%	2011 & 2021

[95-060 Waikalani Drive C302](#) - MLS#: [202411394](#) - Experience the ideal blend of space, style, and affordability in this serene unit that offers the comfort of a single-family home without the high price tag. Nestled at the end of the road in a pet-friendly community, this complex provides gated entry for enhanced privacy and security. Sixty Parkside, a newer building, features an updated sprinkler system in every room and common areas. The community includes an on-site resident manager, two deeded parking spaces, video security, and elevators for easy floor access. Step into a modern, move-in ready space with updated flooring and countertops. Enjoy the convenience of a split AC system, in-unit washer, dryer, and dishwasher. The open kitchen flows into the living room, perfect for entertaining. With a versatile three-bedroom floor plan, you'll have the space you need now and room to grow later. Located in Mililani, you'll be near top-rated schools, great restaurants, and shopping. A short drive takes you to the North Shore's best beaches, surf spots, and snorkeling. Military personnel will enjoy the easy commute to Wheeler Army Airfield and Schofield Barracks. Call your realtor today, Sixty Parkside is ready to welcome you! **Region:** Central **Neighborhood:** Waipio Acres-waikalani Woodlands **Condition:** Excellent, Above Average **Parking:** Covered - 1, Open - 1 **Total Parking:** 2 **View:** Other **Frontage:** **Pool:** **Zoning:** 11 - A-1 Low Density Apartment **Sale Conditions:** None **Schools:** , , \* [Request Showing](#), [Photos](#), [History](#), [Maps](#), [Deed](#), [Watch List](#), [Tax Info](#)

DOM = Days on Market, Occ. = Occupancy, FL = Floor Number