

Modea 168 Queen Street Unit 1202, Honolulu 96813 * \$749,100

Beds: 1	MLS#: 202412117, FS	Year Built: 1972
Bath: 1/0	Status: Active Under Contract	Remodeled:
Living Sq. Ft.: 568	List Date & DOM: 06-11-2024 & 10	Total Parking: 1
Land Sq. Ft.: 0	Condition: Excellent	Assessed Value
Lanai Sq. Ft.: 0	Frontage:	Building: \$598,712
Sq. Ft. Other: 0	Tax/Year: \$187/2024	Land: \$150,388
Total Sq. Ft. 568	Neighborhood: Downtown	Total: \$749,100
Maint./Assoc. \$767 / \$0	Flood Zone : Zone X - Tool	Stories / CPR: / No
Parking: Assigned	Frontage:	
Zoning : 34 - BMX-4 Central Business Mix	View: City, Ocean	

Public Remarks: If breathtaking ocean views are what you desire, look no further than Unit 1202 at Modea. This remarkable condo is downtown Honolulu's first adaptive reuse fee simple condominium. This unit boasts exquisite features including quartz countertops, stainless steel appliances, Italian-designed European-style custom cabinetry, a Fisher & Paykel dishwasher, an in-unit washer/dryer and a deeded parking stall. Modea offers an unparalleled array of amenities to complement your urban lifestyle, including a 3,000 sq ft fitness facility, outdoor cabanas and BBQ spaces, indoor entertaining areas, a chic urban co-work space, a resident club room, a karaoke room, a music room, and a yoga/dance studio. Pet-friendly, this building goes above and beyond with a dedicated dog run and doggy bath on-site. Residents also benefit from 24-hour security, EV charging stations for cars, and guest parking. Don't miss the opportunity to experience cosmopolitan living at its finest at Modea. **Sale Conditions:** None **Schools:** , , * [Request Showing](#), [Photos](#), [History](#), [Maps](#), [Deed](#), [Watch List](#), [Tax Info](#)

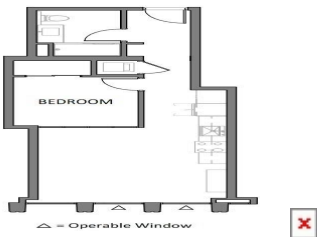

Address	Price	Bd & Bth	Living / Avg.	Land Avg.	DOM
168 Queen Street 1202	\$749,100	1 & 1/0	568 \$1,319	0 \$inf	10

Address	Tax Maint. Ass.	Assessed Land	Assessed Building	Assessed Total	Ratio	Year & Remodeled
168 Queen Street 1202	\$187 \$767 \$0	\$150,388	\$598,712	\$749,100	100%	1972 & NA

168 Queen Street 1202 - MLS#: [202412117](#) - If breathtaking ocean views are what you desire, look no further than Unit 1202 at Modea. This remarkable condo is downtown Honolulu's first adaptive reuse fee simple condominium. This unit boasts exquisite features including quartz countertops, stainless steel appliances, Italian-designed European-style custom cabinetry, a Fisher & Paykel dishwasher, an in-unit washer/dryer and a deeded parking stall. Modea offers an unparalleled array of amenities to complement your urban lifestyle, including a 3,000 sq ft fitness facility, outdoor cabanas and BBQ spaces, indoor entertaining areas, a chic urban co-work space, a resident club room, a karaoke room, a music room, and a yoga/dance studio. Pet-friendly, this building goes above and beyond with a dedicated dog run and doggy bath on-site. Residents also benefit from 24-hour security, EV charging stations for cars, and guest parking. Don't miss the opportunity to experience cosmopolitan living at its finest at Modea. **Region:** Metro **Neighborhood:** Downtown **Condition:** Excellent **Parking:** Assigned **Total Parking:** 1 **View:** City, Ocean **Frontage:** Pool: **Zoning:** 34 - BMX-4 Central Business Mix **Sale Conditions:** None **Schools:** , , * [Request Showing](#), [Photos](#), [History](#), [Maps](#), [Deed](#), [Watch List](#), [Tax Info](#)

DOM = Days on Market