

Nahoa Apts 95-013 Kuahelani Avenue Unit 213, Mililani 96789 * \$440,000

Beds: 2	MLS#: 202414648, FS	Year Built: 1975
Bath: 1/0	Status: Active	Remodeled:
Living Sq. Ft.: 764	List Date & DOM: 06-25-2024 & 5	Total Parking: 1
Land Sq. Ft.: 433,901	Condition: Above Average	Assessed Value
Lanai Sq. Ft.: 0	Frontage:	Building: \$256,200
Sq. Ft. Other: 0	Tax/Year: \$123/2023	Land: \$166,600
Total Sq. Ft. 764	Neighborhood: Mililani Area	Total: \$422,800
Maint./Assoc. \$450 / \$49	Flood Zone : Zone D - Tool	Stories / CPR: Two / No
Parking: Assigned, Guest, Open - 1, Street	Frontage:	
Zoning : 12 - A-2 Medium Density Apartme	View: Garden, Mountain	

Public Remarks: Nahoa Apartments is centrally located in Mililani on the island of Oahu. This is a 2 bedroom/1 bath/1 parking condo on the 2nd floor of a three story walk-up. Enter a spacious living area with ample space for entertaining and relaxing. The kitchen features a bar counter adjacent to the dining space with room for a dining room table or office. Parking and community laundry are nearby and the complex is pet friendly. Feel the cooling mauka breezes offering great cross ventilation. Easy to see. Schedule your appointment today! **Sale Conditions:** None **Schools:** , , * [Request Showing](#), [Photos](#), [History](#), [Maps](#), [Deed](#), [Watch List](#), [Tax Info](#)

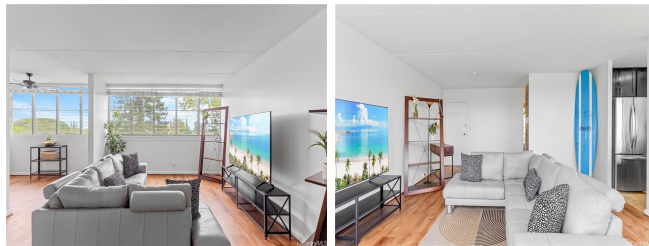

Address	Price	Bd & Bth	Living / Avg.	Land Avg.	DOM
95-013 Kuahelani Avenue 213	\$440,000	2 & 1/0	764 \$576	433,901 \$1	5

Address	Tax Maint. Ass.	Assessed Land	Assessed Building	Assessed Total	Ratio	Year & Remodeled
95-013 Kuahelani Avenue 213	\$123 \$450 \$49	\$166,600	\$256,200	\$422,800	104%	1975 & NA

[95-013 Kuahelani Avenue 213](#) - MLS#: [202414648](#) - Nahoa Apartments is centrally located in Mililani on the island of Oahu. This is a 2 bedroom/1 bath/1 parking condo on the 2nd floor of a three story walk-up. Enter a spacious living area with ample space for entertaining and relaxing. The kitchen features a bar counter adjacent to the dining space with room for a dining room table or office. Parking and community laundry are nearby and the complex is pet friendly. Feel the cooling mauka breezes offering great cross ventilation. Easy to see. Schedule your appointment today! **Region:** Central **Neighborhood:** Mililani Area **Condition:** Above Average **Parking:** Assigned, Guest, Open - 1, Street **Total Parking:** 1 **View:** Garden, Mountain **Frontage:** **Pool:** **Zoning:** 12 - A-2 Medium Density Apartme **Sale Conditions:** None **Schools:** , , * [Request Showing](#), [Photos](#), [History](#), [Maps](#), [Deed](#), [Watch List](#), [Tax Info](#)

DOM = Days on Market